



PZR-UV系列卷材(软膜)喷绘机

Maxima Inno UV Inkjet Printer (Soft film Optional)



LED/汞灯
UV Roll to Roll

2880

DPI print quality

1440

For high precision prints
Provides excellent results.

3,2m

Print Width

9 PL
14 PL

10年UV数码设备生产服务经验，最新软膜、内打灯软材打印利器！

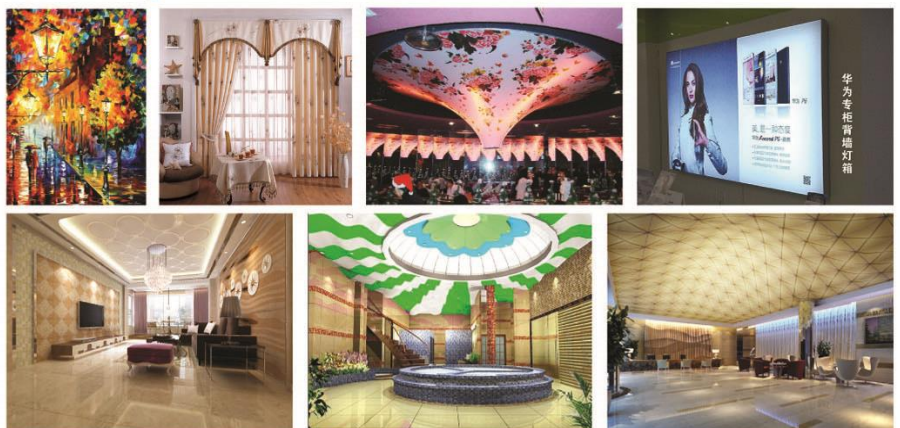

Sole Distributor / 全马总代理:

Color OceanTM

Colorocean Technologies (M) Sdn Bhd

功能特点 / Highlight Features:

- 1, PZR-UV系列, 是理想的高精高速型大幅面UV纯卷喷绘机, 机器采用KONICA公司KM1024UV工业级喷头, 最高精度可达2880DPI, 专业写真效果。
The Maxima Inno UV Inkjet printer is ideal for large-volume roll to roll uv production printing in excellent quality with innovative Konica Minolta KM1024 industrial UV print-head, Max. Resolution up to 2880dpi, professional indoor quality.
- 2, 重型机体, 最高支持12只KM1024工业级UV喷头, 双四色、双六色可选, 支持彩白彩多层打印一次完成。
Heavy structure, Max. support 12 pcs of KM1024 industrial UV printhead.
- 3, 进口高精度静音直线导轨, 进口松下伺服电机提高喷车运行精度、降低噪音;
Famous imported high-precision & silent linear guider, Panasonic servo motor enable higher carriage speed and lower noise.
- 4, 全新的压轮电动抬落设计, 机器前后均设置操作按钮, 操作更方便快捷。
Brand new design of pinch roller auto lifting up and down system with pre and post button controllers, operation much more easy.
- 5, 全新色彩处理技术, 内打灯打印完美表现。
New generation of color management, perfect performance of backlit printing.
- 6, 可调小车升降装置, 适应不同厚度的打印介质, 调整方便。
Adjustable carriage up & down system, available with different thickness of material, Convenient adjustment.
7. 可选配先进的LED灯固化技术, 安全、节能、环保。
Optional LED lamp curing technology, safety, energy saving, environmental protection.
8. 针对打软膜而设计的前后张力调节系统, 可根据软膜材质手动调整张力大小, 使软膜打印进给时平整精准; 软膜与其它介质转换调整方便, 通用性好, 机器对介质的使用范围进一步扩大, 经济高效。
Front/Rear tension adjustable system specially designed for softfilm. Tension strength can be adjusted according to different softfilm material which enables accurate feeding during printing. Easy exchanging softfilm with other materials, universal, thus more materials is available, economic high efficiency.
9. 应用领域: 餐厅、商场、综艺体育场所、机场、地铁站、高铁站、软膜灯箱、软膜天花等。
Applications: Restaurant, Super Market, Art & entertainment halls, Airport, stations, soft film light box, soft film ceiling decoration, etc.



技术参数 / Technical Specifications

型号/Model	PZR3204 /PZR3205/PZR3206-KA-1	PZR3208 /PZR3210/PZR3212-KA-1	墨水类型/Ink type	K/C/M/Y 或K/C/M/Y/Lc/Lm 或K/C/M/Y/W或K/C/M/Y/W/V	
打印技术/Print Tech.	压电喷墨技术/Piezo continuous drop-on demand (DOD)		打印接口/Interface	USB2.0	
喷头/Print head	4/5/6 x KM1024MHB	8/10/12x KM1024MHB	自动收放布系统 Auto.take-up and feeding system	标配 前后张力系统/Standard front/back tension system 选配 单双辊放料/Optional single/double roller feeding	
最高分辨率/Max.Resolution	720 x 2880dpi		台面承重/Table Pressure	50kg/㎡	
打印宽度/Image Size	3.2m/126in.		机器尺寸 Machine Size(w×d×h)	4.82m x1.04m x1.52m	
进纸宽度/Media Size	3.29m/130in.		包装箱尺寸 Packing Size(w×d×h)	5.00m x1.08m x 1.77m	
介质类别 Media Type	软膜、透明膜、墙纸、塑料/乳胶、树脂材料、灯箱布、即时贴、单透、车身贴 Soft film, wallpaper, plastic / emulsion, resin material, light box cloth, vinyl, single transparent, body paste		毛重/G.Weight	750kg	
介质传输 Media Transmission	卷对卷/Roll to Roll		电源要求 Power Requirement	AC 110/220V±10% >10A 60/50Hz	
打印速度 Printing Speed	草稿模式 Draft Mode	75㎡/h	150㎡/h	工作环境/ Environment	温度: 10 ~ 30℃, 湿度: 40~70%RH/Temperature: 10 ~ 30℃, Humidity: 40~70%RH
	生产模式 Production Mode	50㎡/h	100㎡/h	户外耐候性/Outdoor Durability	2年 two years
	高精模式 Quality Mode	38㎡/h	76㎡/h		

以上数据如有更改, 恕不另行通知, 解释权归安徽力宇公司所有
Specifications are subject to change without prior notice, all rights reserved.